



IT DEPARTMENT

User manual

VPN using MFA

User manual

A guide on how to connect
to ITU VPN with MFA

© IT Department at the IT University of Copenhagen
Rued Langgaards Vej 7
2300 Copenhagen S

All rights reserved.

Last updated July 2024.

IT DEPARTMENT

1

Set-Up
Multi-Factor
Authentication
to VPN

1.1

Please follow the guide below to setup Microsoft Authenticator application to the VPN service.

VPN on private computer, approve by using Microsoft Authenticator app on your mobile device.

<https://itustudent.itu.dk/campus-life/it-services/remote-access>

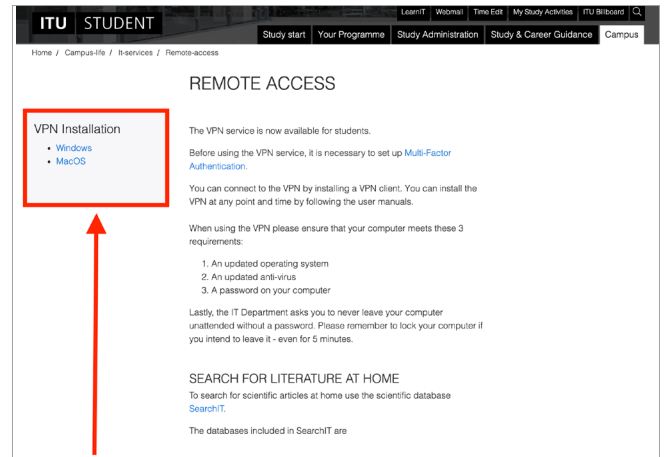

1.2

Open a web browser on your computer and go to this link:

<https://go.itu.dk/mfasetup>

Login with your ITU email address and then click on Next.

See if the Default sign-in method is: Microsoft Authenticator - notification.

If it is 'Microsoft Authenticator - notification' skip step 1.2 and 1.3, continue to step 1.4. If it's not set to: 'Microsoft Authenticator - notification', setup in step 1.2.

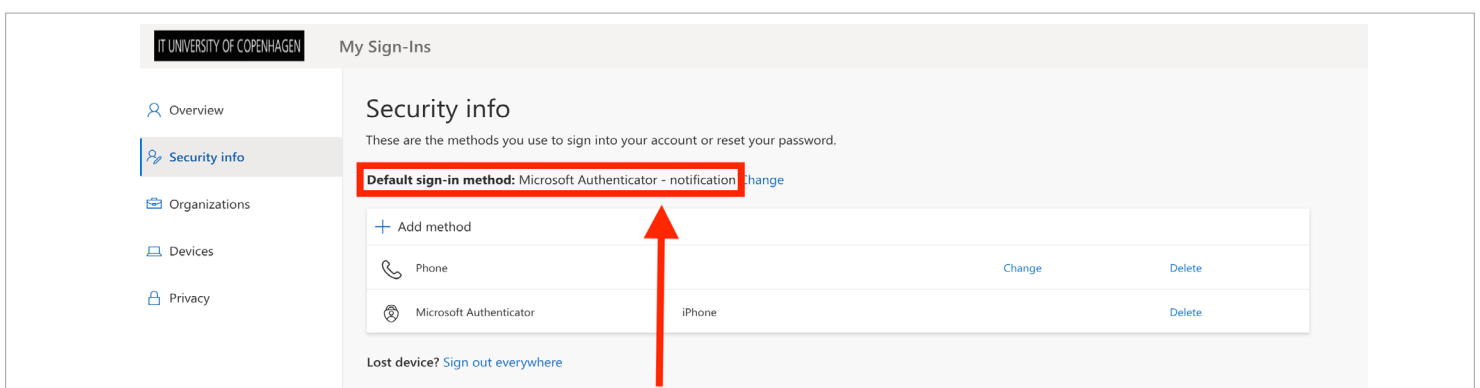

1.3

If the Default sign-in method is not set to: Microsoft Authenticator - notification.

Click on + Add method to setup

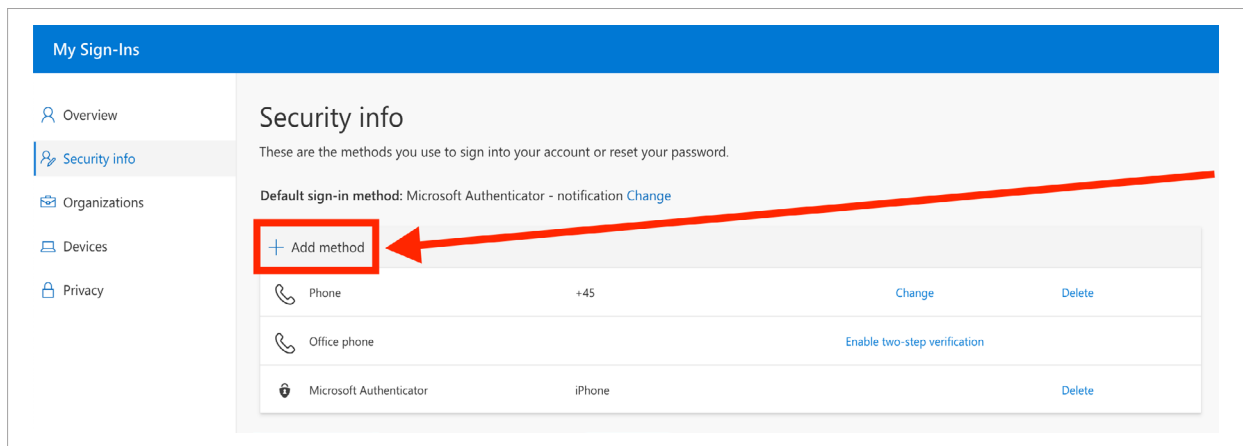

1.4

Choose **Authenticator app** and then click on **Add**. Follow the instructions on the screen.

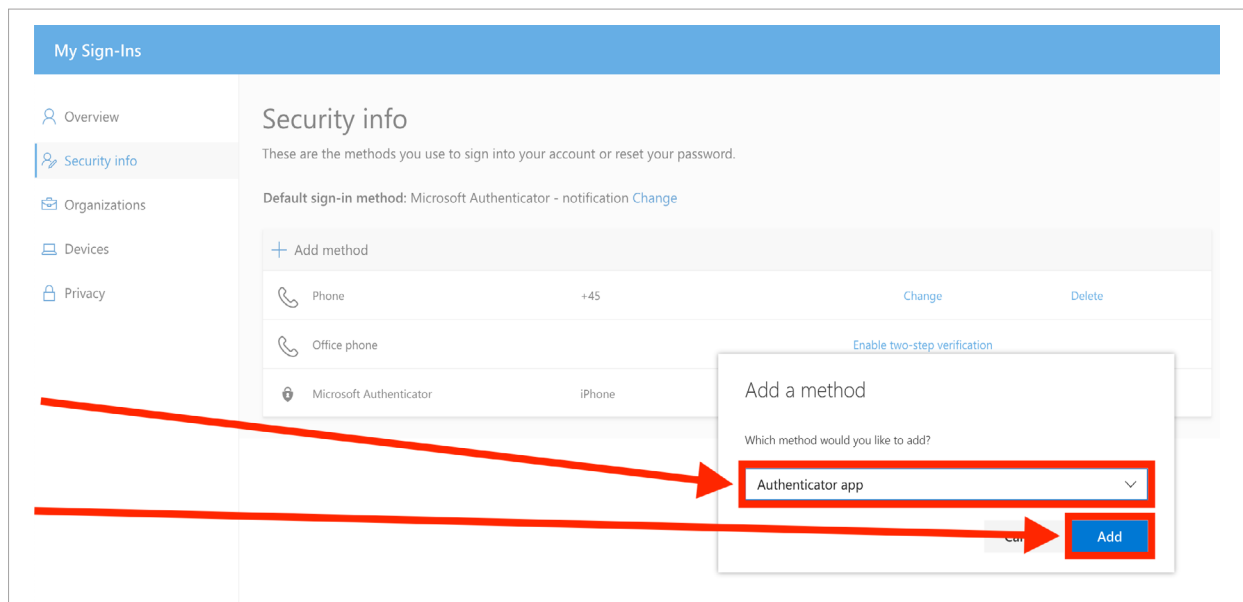

2

Set-Up FortiClient VPN

2.1

Please make sure you to download and install the free version named FortiClient VPN:
<https://www.fortinet.com/support/product-downloads#vpn>

Warning: Do not download the paid version of FortiClient application
(Paid version requires a license).

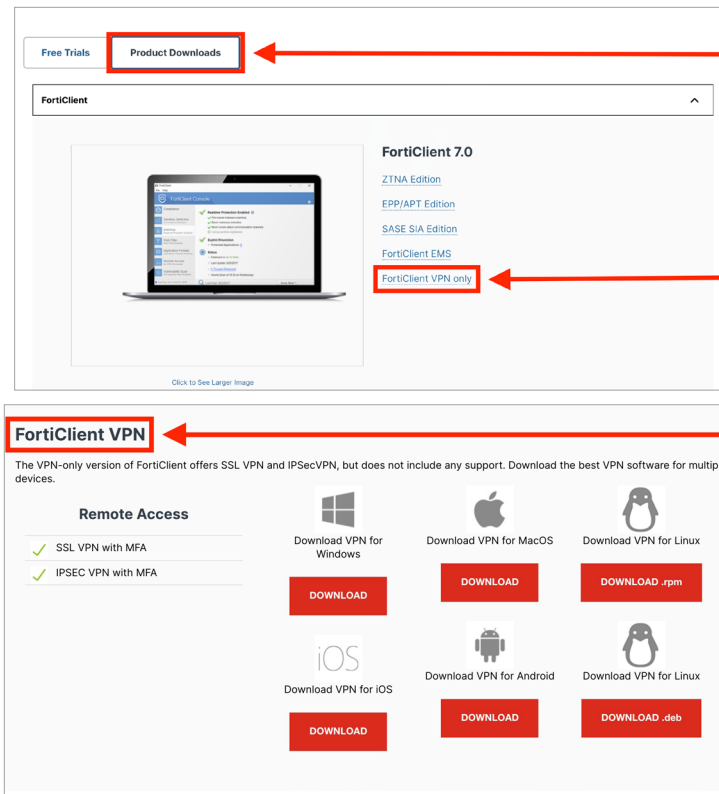

2.2

Open FortiClient VPN application and click Configure VPN.

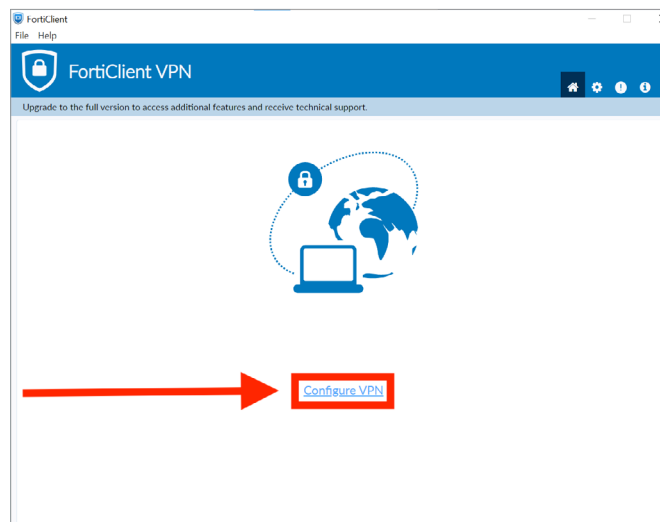

2.3

Fill out Connection Name:
ITU VPN MFA

Fill out Remote Gateway:
sslvpn.itu.dk/MFA

Click on Save.

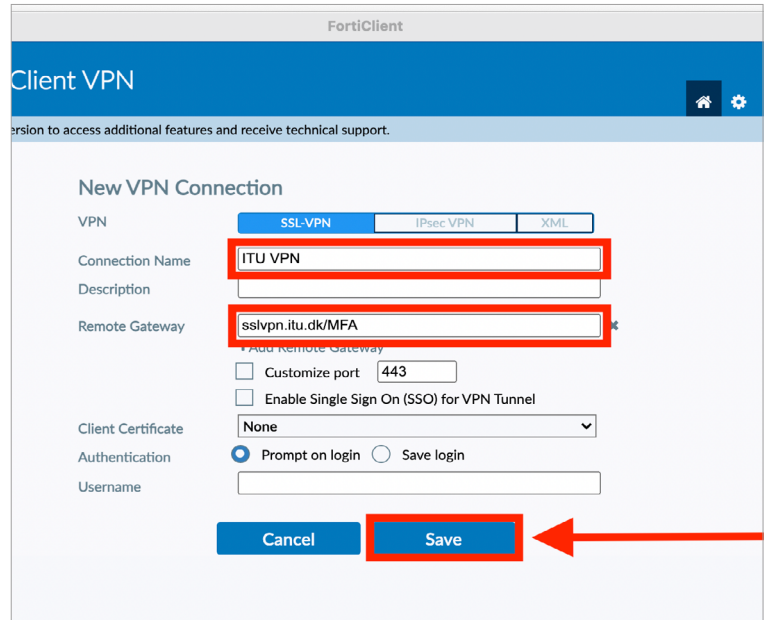

FortiClient
Client VPN

Upgrade to the full version to access additional features and receive technical support.

New VPN Connection

VPN: **SSL-VPN** | IPsec VPN | XML

Connection Name: **ITU VPN**

Description:

Remote Gateway: **sslvpn.itu.dk/MFA**

+ Add Remote Gateway

Customize port: 443

Enable Single Sign On (SSO) for VPN Tunnel

Client Certificate: **None**

Authentication: Prompt on login Save login

Username:

Cancel **Save**

2.4

Type your **ITU username** or your **ITU email address (@itu.dk)** and password, and click on *Connect*.

FortiClient VPN application will send a notification to your mobile phone, approve by using **Microsoft Authenticator app** on your mobile device.

You have exactly 3 minutes to approve or else you will get a Connection Error.

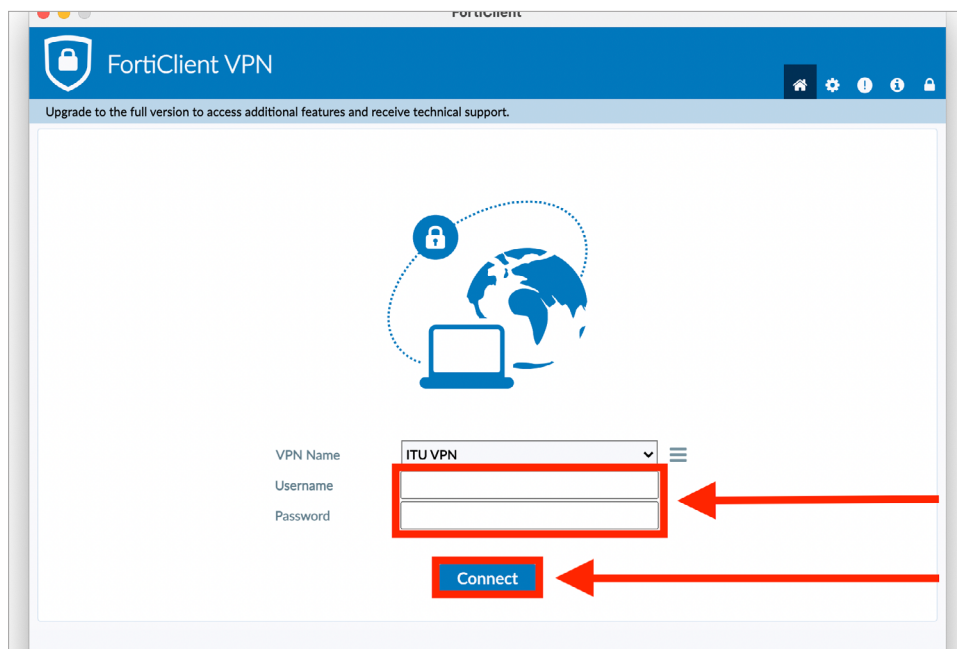

FortiClient VPN

Upgrade to the full version to access additional features and receive technical support.

VPN Name: **ITU VPN**

Username:

Password:

Connect

IT DEPARTMENT

IT University of Copenhagen
Rued Langgaards Vej 7
2300 Copenhagen S

Opening hours:
Monday - Friday
10 AM to 13 PM
Wing 2C

it@itu.dk